

šestihranný s plochou hlavou

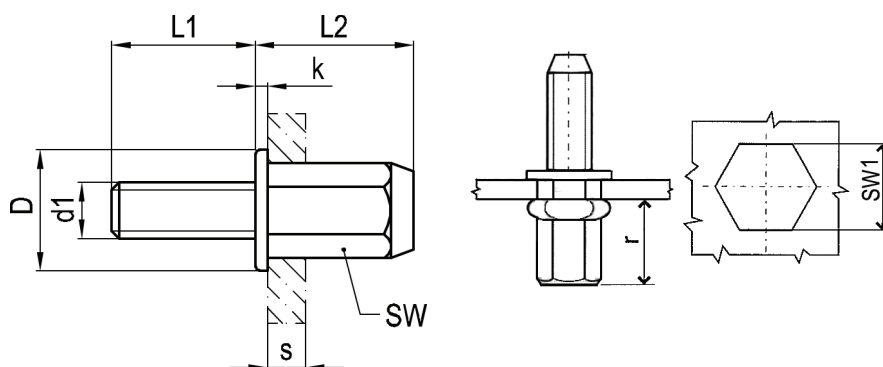

Materiál: ocel zinkovaná

d1	SW1 mm +0,1	s mm	r (mm) min-max *)	SW mm (max)	D mm	k mm	L 1 mm	L 2 mm	tt-číslo
M 5	7,0	0,5 – 3,0	5,0 – 5,5	6,9	10,0	1,0	15,0	12,0	24 231 50.152
							20,0		
							25,0		
M 6	9,0	0,5 – 3,0	7,0 – 7,5	8,9	13,0	1,5	15,0	14,5	24 231 65.152
							20,0		
							25,0		
M 8	11,0	0,5 – 3,0	8,0 – 8,5	10,9	16,0	1,5	20,0	15,5	24 231 85.202
							25,0		